

**TYPE D (3B + 3T)**

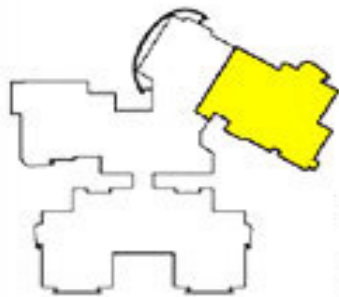

**Disclaimer:**

- The areas and plans shown here are subject to change
- 1 sq. ft. = 0.093 sq. mt., 10.764 sq. ft. = 1 sq. mt. = 1.196 sq. yd and 3.28 ft. = 1 mt.
- All dimensions shown in feet, inches are close approximation to metric dimensions
- The above plans are indicative. Please check actual plans with marketing